

GROMMETS

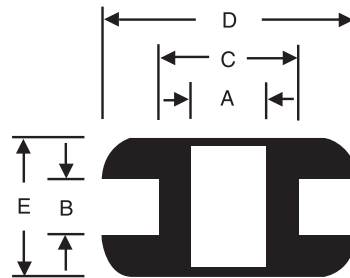

----- **Military Standard Grommets** -----



MS-35489 Military Standard Grommets

Supersedes AN-931. Rubber, hot-oil and coolant resistant material specification MIL-G-3036.

AN-931 Army-Navy Standard Grommets

To procurement specification AN-G-21. Rubber, hot-oil and coolant resistant material specification MIL-G-3036.

Round Shoulders Unequal Width

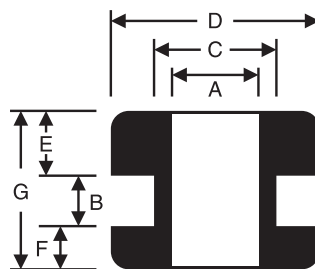

| RPM Part Number | A Bore Diameter | B Groove Width | C Groove Diameter | D Outside Diameter | E Shoulder Sm. Width | F Shoulder Lrg. Width | G Overall Thickness |
|-----------------|-----------------|----------------|-------------------|--------------------|----------------------|-----------------------|---------------------|
| GRO-0156-03 | 5/32 | 1/16 | 9/32 | 15/32 | 7/64 | 1/8 | 19/64 |
| GRO-0250-10 | 1/4 | 1/16 | 9/16 | 3/4 | 3/64 | 1/16 | 11/64 |
| GRO-0250-11 | 1/4 | 3/32 | 7/16 | 5/8 | 3/32 | 3/16 | 3/8 |

Measured in inches

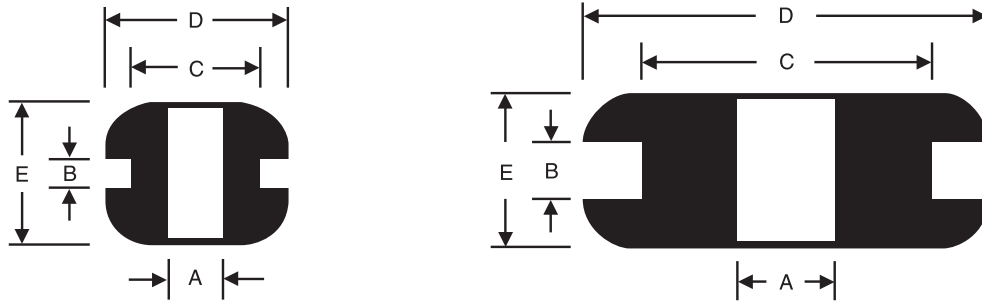

| RPM Part Number | A Bore Diameter | B Groove Width | C Groove Diameter | D Outside Diameter | E Overall Thickness |
|-----------------|-----------------|----------------|-------------------|--------------------|---------------------|
| GRO-0109-01 | 7/64 | 3/64 | 1/2 | 11/16 | 9/32 |
| GRO-0125-01 | 1/8 | 1/32 | 3/16 | 1/4 | 3/32 |
| GRO-0125-02 | 1/8 | 1/16 | 1/4 | 11/32 | 3/16 |
| GRO-0125-03 | 1/8 | 3/32 | 3/8 | 1/2 | 5/16 |
| GRO-0156-01 | 5/32 | 1/16 | 1/4 | 3/8 | 3/16 |
| GRO-0156-02 | 5/32 | 3/32 | 1/4 | 7/16 | 3/8 |
| GRO-0188-01 | 3/16 | 1/32 | 5/16 | 7/16 | 7/32 |
| GRO-0188-03 | 3/16 | 1/16 | 5/16 | 7/16 | 3/16 |
| GRO-0188-04 | 3/16 | 1/16 | 5/16 | 1/2 | 1/4 |
| GRO-0188-05 | 3/16 | 1/16 | 9/16 | 3/4 | 3/16 |
| GRO-0188-06 | 3/16 | 3/32 | 9/32 | 7/16 | 7/32 |
| GRO-0188-07 | 3/16 | 1/8 | 5/16 | 7/16 | 1/4 |
| GRO-0188-08 | 3/16 | 3/16 | 5/16 | 7/16 | 5/16 |
| GRO-0188-09 | 3/16 | 1/4 | 5/16 | 7/16 | 3/8 |
| GRO-0188-11 | 3/16 | 1/8 | 9/16 | 3/4 | 1/4 |
| GRO-0203-01 | 13/64 | 1/8 | 13/32 | 9/16 | 3/8 |
| GRO-0218-01 | 7/32 | 1/16 | 5/16 | 7/16 | 3/16 |
| GRO-0250-01 | 1/4 | 1/16 | 3/8 | 1/2 | 1/4 |
| GRO-0250-02 | 1/4 | 1/16 | 7/16 | 5/8 | 3/16 |
| GRO-0250-03 | 1/4 | 1/16 | 1 | 1-1/4 | 1/4 |
| GRO-0250-04 | 1/4 | 3/32 | 3/8+ | 1/2 | 1/4 |
| GRO-0250-05 | 1/4 | 1/8 | 3/8+ | 1/2 | 9/32 |
| GRO-0250-06 | 1/4 | 1/8 | 7/16 | 5/8 | 1/4 |
| GRO-0250-07 | 1/4 | 3/16 | 7/16 | 5/8 | 5/16 |
| GRO-0250-08 | 1/4 | 1/4 | 7/16 | 5/8 | 3/8 |
| GRO-0281-01 | 9/32 | 1/16 | 3/8 | 9/16 | 1/4 |
| GRO-0281-02 | 9/32 | 1/4 | 15/32 | 11/16 | 7/16 |
| GRO-0313-01 | 5/16 | 1/16 | 7/16 | 5/8 | 9/32 |
| GRO-0313-02 | 5/16 | 1/16 | 9/16 | 13/16 | 5/16 |
| GRO-0313-03 | 5/16 | 1/16 | 3/4 | 1 | 5/16 |
| GRO-0313-04 | 5/16 | 3/32 | 7/16 | 5/8 | 5/16 |
| GRO-0313-05 | 5/16 | 1/8 | 9/16 | 13/16 | 3/8 |
| GRO-0313-06 | 5/16 | 1/8 | 3/4 | 1 | 3/8 |
| GRO-0313-07 | 5/16 | 3/16 | 9/16 | 13/16 | 7/16 |
| GRO-0313-08 | 5/16 | 3/16 | 3/4 | 1 | 7/16 |

Measured in inches

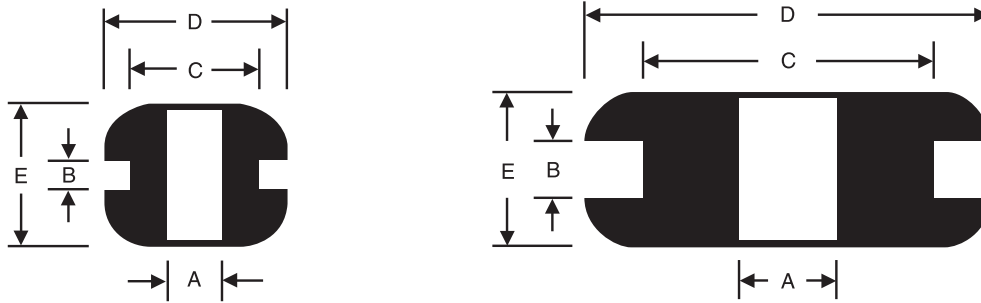

| RPM Part Number | A Bore Diameter | B Groove Width | C Groove Diameter | D Outside Diameter | E Overall Thickness |
|-----------------|-----------------|----------------|-------------------|--------------------|---------------------|
| GRO-0313-09 | 5/16 | 1/4 | 9/16 | 13/16 | 1/2 |
| GRO-0313-10 | 5/16 | 1/4 | 3/4 | 1 | 1/2 |
| GRO-0375-01 | 3/8 | 1/16 | 1/2 | 5/8 | 1/4 |
| GRO-0375-02 | 3/8 | 1/16 | 1/2 | 11/16 | 9/32 |
| GRO-0375-03 | 3/8 | 1/16 | 5/8 | 7/8 | 5/16 |
| GRO-0375-04 | 3/8 | 1/16 | 1 | 1-1/4 | 1/4 |
| GRO-0375-05 | 3/8 | 1/8 | 5/8 | 7/8 | 3/8 |
| GRO-0375-06 | 3/8 | 3/16 | 5/8 | 7/8 | 7/16 |
| GRO-0375-07 | 3/8 | 1/4 | 1/2 | 3/4 | 1/2 |
| GRO-0375-08 | 3/8 | 1/4 | 5/8 | 7/8 | 1/2 |
| GRO-0437-01 | 7/16 | 1/16 | 9/16 | 3/4 | 1/4 |
| GRO-0437-02 | 7/16 | 1/16 | 11/16 | 15/16 | 5/16 |
| GRO-0437-03 | 7/16 | 1/8 | 11/16 | 15/16 | 3/8 |
| GRO-0437-04 | 7/16 | 3/16 | 9/16 | 11/16 | 3/8 |
| GRO-0437-05 | 7/16 | 3/16 | 11/16 | 15/16 | 7/16 |
| GRO-0437-06 | 7/16 | 1/4 | 11/16 | 15/16 | 1/2 |
| GRO-0500-01 | 1/2 | 1/16 | 13/16 | 1-1/16 | 5/16 |
| GRO-0500-02 | 1/2 | 1/16 | 1 | 1-1/4 | 1/4 |
| GRO-0500-03 | 1/2 | 1/16 | 1-1/4 | 1-1/2 | 1/4 |
| GRO-0500-04 | 1/2 | 3/32 | 3/4 | 31/32 | 9/32 |
| GRO-0500-05 | 1/2 | 1/8 | 3/4 | 1 | 1/2 |
| GRO-0500-06 | 1/2 | 3/16 | 13/16 | 1-1/16 | 7/16 |
| GRO-0500-07 | 1/2 | 1/4 | 13/16 | 1-1/16 | 1/2 |
| GRO-0500-08 | 1/2 | 3/8 | 3/4 | 1 | 5/8 |
| GRO-0500-12 | 1/2 | 1/8 | 13/16 | 1-1/16 | 3/8 |
| GRO-0562-01 | 9/16 | 1/16 | 13/16 | 1-1/16 | 5/16 |
| GRO-0562-02 | 9/16 | 3/16 | 7/8 | 1-1/16 | 7/16 |
| GRO-0562-03 | 9/16 | 1/4 | 13/16 | 1-1/16 | 1/2 |
| GRO-0562-04 | 9/16 | 3/8 | 7/8 | 1-1/16 | 5/8 |
| GRO-0562-05 | 9/16 | 1 | 13/16 | 1-1/8 | 1-1/4 |
| GRO-0562-06 | 9/16 | 1/8 | 13/16 | 1-1/16 | 3/8 |
| GRO-0625-01 | 5/8 | 1/16 | 7/8 | 1-1/8 | 5/16 |
| GRO-0625-02 | 5/8 | 1/16 | 1-1/4 | 1-1/2 | 1/4 |
| GRO-0625-03 | 5/8 | 1/8 | 7/8 | 1-1/8 | 3/8 |
| GRO-0625-04 | 5/8 | 3/16 | 7/8 | 1-1/8 | 7/16 |

Measured in inches

| RPM Part Number | A Bore Diameter | B Groove Width | C Groove Diameter | D Outside Diameter | E Overall Thickness |
|-----------------|-----------------|----------------|-------------------|--------------------|---------------------|
| GRO-0625-05 | 5/8 | 1/4 | 7/8 | 1-1/8 | 1/2 |
| GRO-0687-01 | 11/16 | 1/16 | 1 | 1-5/16 | 3/8 |
| GRO-0687-02 | 11/16 | 1/8 | 1 | 1-5/16 | 7/16 |
| GRO-0687-03 | 11/16 | 3/16 | 1 | 1-5/16 | 1/2 |
| GRO-0687-04 | 11/16 | 1/4 | 1 | 1-5/16 | 9/16 |
| GRO-0750-01 | 3/4 | 1/16 | 1-1/16 | 1-3/8 | 3/8 |
| GRO-0750-02 | 3/4 | 1/16 | 1-1/4 | 1-5/8 | 1/4 |
| GRO-0750-03 | 3/4 | 1/16 | 1-7/16 | 1-13/16 | 3/8 |
| GRO-0750-04 | 3/4 | 1/8 | 1-1/16 | 1-3/8 | 7/16 |
| GRO-0750-05 | 3/4 | 3/16 | 1-1/16 | 1-3/8 | 1/2 |
| GRO-0750-06 | 3/4 | 1/4 | 1-1/16 | 1-3/8 | 9/16 |
| GRO-0875-01 | 7/8 | 1/16 | 1-1/4 | 1-5/8 | 7/16 |
| GRO-0875-02 | 7/8 | 1/16 | 1-5/8 | 2 | 7/16 |
| GRO-0875-03 | 7/8 | 5/64 | 1-3/16 | 1-3/8 | 15/32 |
| GRO-0875-04 | 7/8 | 1/8 | 1-1/4 | 1-5/8 | 1/2 |
| GRO-0875-05 | 7/8 | 9/64 | 1-3/16 | 1-3/8 | 15/32 |
| GRO-0875-06 | 7/8 | 3/16 | 1-1/4 | 1-5/8 | 9/16 |
| GRO-0875-07 | 7/8 | 1/4 | 1-1/4 | 1-5/8 | 5/8 |
| GRO-1000-01 | 1 | 1/16 | 1-3/8 | 1-3/4 | 7/16 |
| GRO-1000-02 | 1 | 1/8 | 1-3/8 | 1-3/4 | 1/2 |
| GRO-1000-03 | 1 | 3/16 | 1-3/8 | 1-3/4 | 9/16 |
| GRO-1000-04 | 1 | 1/4 | 1-1/4 | 1-1/2 | 1/2 |
| GRO-1000-05 | 1 | 1/4 | 1-3/8 | 1-3/4 | 5/8 |
| GRO-1125-01 | 1-1/8 | 1/16 | 1-1/2 | 1-7/8 | 3/8 |
| GRO-1250-01 | 1-1/4 | 3/32 | 1-1/2 | 1-7/8 | 3/8 |
| GRO-1313-01 | 1-5/16 | 1/16 | 1-5/8 | 2 | 3/8 |
| GRO-1313-02 | 1-5/16 | 1/8 | 1-5/8 | 2 | 7/16 |
| GRO-1500-01 | 1-1/2 | 1/16 | 1-3/4 | 2-1/8 | 7/16 |
| GRO-1500-02 | 1-1/2 | 3/32 | 2 | 2-3/8 | 3/8 |
| GRO-1500-03 | 1-1/2 | 1/8 | 1-3/4 | 2-1/8 | 1/2 |
| GRO-1500-04 | 1-1/2 | 3/16 | 1-3/4 | 2-1/8 | 9/16 |
| GRO-1500-05 | 1-1/2 | 1/4 | 1-3/4 | 2-1/8 | 5/8 |
| GRO-2125-01 | 2-1/8 | 1/16 | 2-1/2 | 2-7/8 | 7/16 |
| GRO-2125-02 | 2-1/8 | 1/8 | 2-1/2 | 2-7/8 | 1/2 |

Measured in inches

Unequal Shoulders Diameter

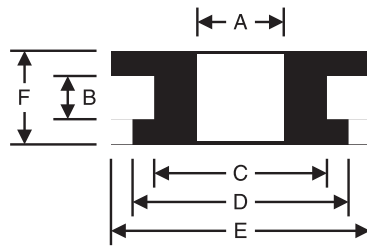

| RPM Part Number | A Bore Diameter | B Groove Width | C Groove Diameter | D Shoulder Sm. Diameter | E Shoulder Lrg. Diameter | F Overall Thickness |
|-----------------|-----------------|----------------|-------------------|-------------------------|--------------------------|---------------------|
| GRO-0500-09 | 1/2 | 3/32 | 1-3/8 | 1-5/8 | 1-7/8 | 1/4 |
| GRO-0625-06 | 5/8 | 3/32 | 1-3/8 | 1-5/8 | 1-7/8 | 1/4 |

Measured in inches

Plain Bore Square Shoulders

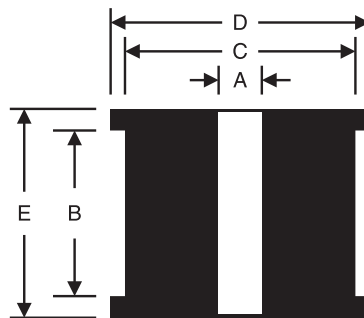

| RPM Part Number | A Bore Diameter | B Groove Width | C Groove Diameter | D Outside Diameter | E Overall Thickness |
|-----------------|-----------------|----------------|-------------------|--------------------|---------------------|
| GRO-0313-11 | 5/16 | 3/8 | 3/8 | 9/16 | 1/2 |
| GRO-0375-09 | 3/8 | 1/8 | 1/2 | 5/8 | 13/32 |
| GRO-0625-07 | 5/8 | 5/8 | 7/8 | 1-1/16 | 7/8 |

Measured in inches

GRO-0188-10

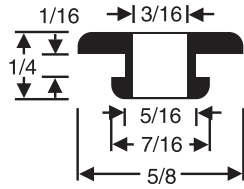

GRO-0375-10

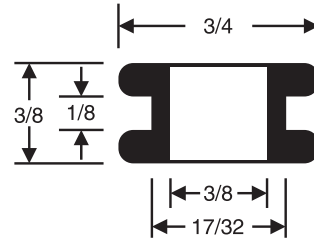

Plain Bore Rolled Shoulders

GRO-0500-10

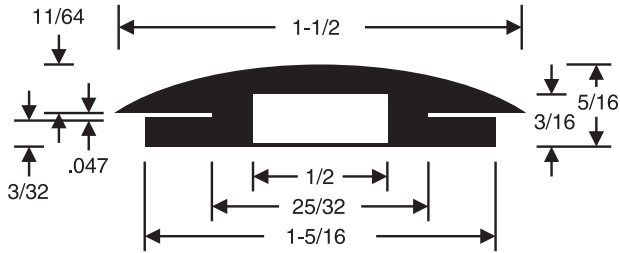

GRO-0500-11

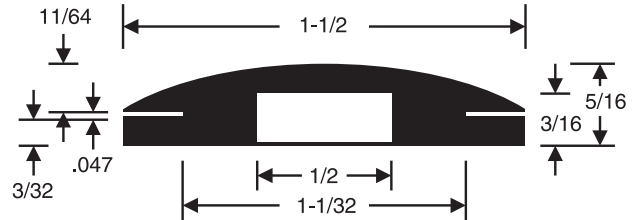

GRO-0625-08

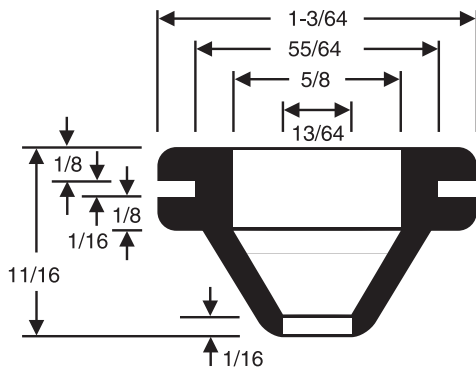

GRO-0687-05

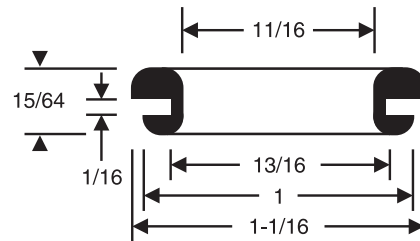

Chamfered Bore Rounded Shoulders

Measured in inches

GRO-0188-10

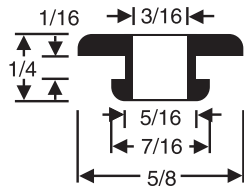

GRO-0375-10

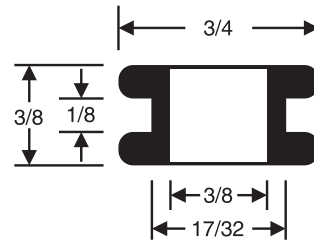

Plain Bore Rolled Shoulders

GRO-0500-10

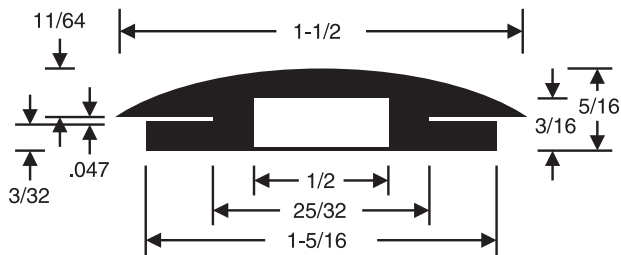

GRO-0500-11

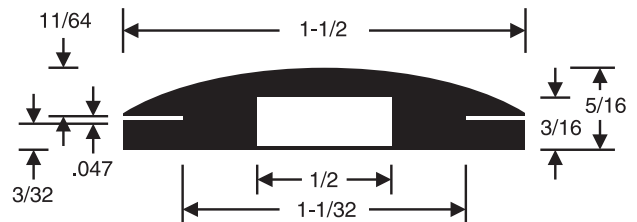

GRO-0625-08

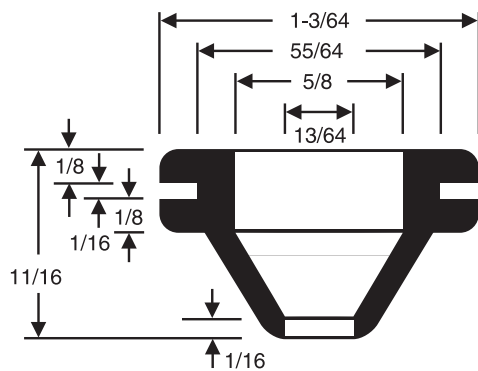

GRO-0687-05

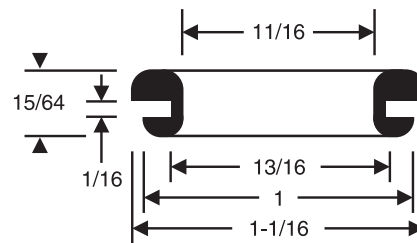

Chamfered Bore Rounded Shoulders

Chamfered Bore

Measured in inches



UNABLE TO FIND THE PART YOU REQUIRE?

Contact our customer service representative for information on the many additional custom standard parts we have available.